



1 Jutland House Dedworth Road, Windsor, SL4 5BE
£250,000

 **HORLER**

1 Jutland House Dedworth Road, Windsor, SL4 5BE

Well-presented ground floor apartment located in a quiet cul-de-sac off Dedworth Road, Windsor. The property offers a spacious reception room, one generous double bedroom, a modern fitted kitchen, and a stylish bathroom. Residents also benefit from communal gardens and convenient access to local amenities, making it an ideal home for individuals, couples, or investors seeking comfortable living in a desirable location.



Property Summary

Located in a cul-de-sac off the Dedworth Road in the charming town of Windsor, this delightful ground floor apartment offers a perfect blend of comfort and modern living. The property features a spacious reception room that welcomes you with warmth and light, making it an ideal space for relaxation or entertaining guests.

The apartment boasts one generously sized double bedroom, providing a peaceful retreat for rest and rejuvenation. The modern fitted kitchen is equipped with contemporary appliances, ensuring that cooking is a pleasure rather than a chore. The stylish bathroom complements the apartment's modern aesthetic, offering a serene space for your daily routines.

Residents will also appreciate the communal gardens, which provide a lovely outdoor area to enjoy fresh air and greenery. This apartment is perfect for individuals or couples seeking a convenient and comfortable home in a sought-after location.

With its proximity to local amenities and the picturesque surroundings of Windsor, this property presents an excellent opportunity for those looking to embrace a vibrant lifestyle. Whether you are a first-time buyer or seeking a rental investment, this charming flat is sure to impress.

General Information

Lease remaining: 990

Service charge: Approx. £700.00 per year

Legal Note

Although these particulars are thought to be materially correct their accuracy cannot be guaranteed and they do not form part of any contract





Jutland House SL4

Approximate Gross Internal Floor Area = 47.0 sq m / 506 sq ft

Store Area = 1.6 sq m / 18 sq ft

Total Area = 48.6 sq m / 524 sq ft

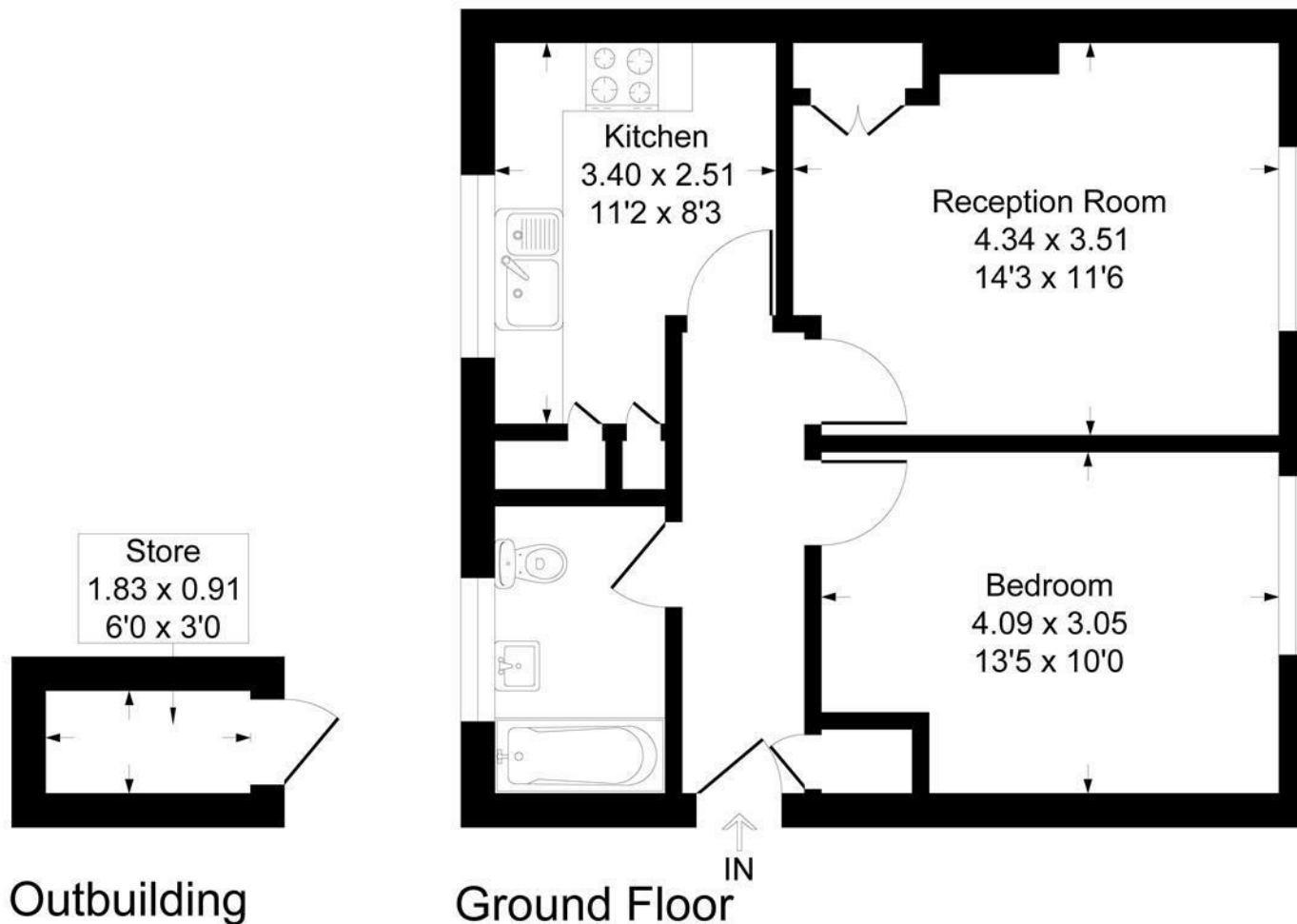

Illustration for identification purposes only, measurements are approximate, not to scale.

Produced By Esjay Property Marketing